

# Instruction

Collection: Diamant crystal  
 Series: Basfor  
 Model: DIA100-CL-12-N  
 Pendant lamp

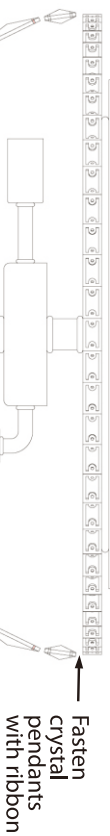

A = 1  
 B = 32  
 C = 63

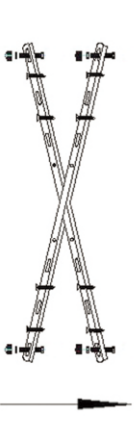
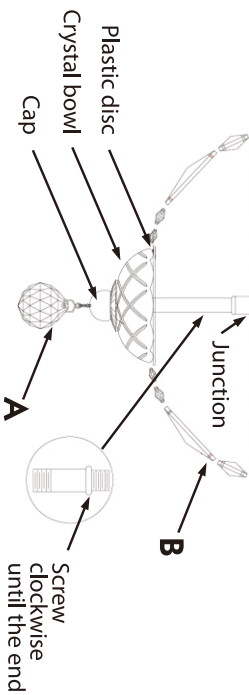

Screw  
 clockwise  
 until the end

Place the handset firmly fix it.  
 Then put in the following sequence:

- plastic disc
- crystal bowl
- cap
- hang crystal ball (part A)

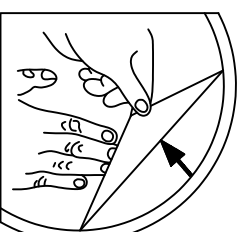

REMOVE COVER  
 BEFORE USING LAMP

- Step by step action:
- Place the chandelier:
- Screw lamps (not included)
- Check the chandelier - light on all lamps
- Place the handset and Hang crystal ball (part A)
- Place crystal pendants (part B)
- Place crystal pendants (part C)



– Pendant lamp

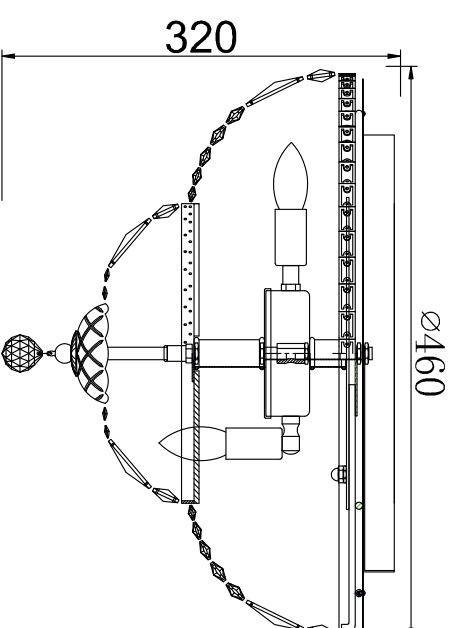

12 x E14 (60w)



**MAYTONI**  
 DECORATIVE LIGHTING

www.maytoni.de